

PARCEL LEGEND					
AREA	ACRES	PROPERTY OWNER	DATE ACQUIRED	TO BE ACQUIRED	SOURCE
1	1074.5	CITY OF PASO ROBLES	1973		CITY
2	102.1	CITY OF PASO ROBLES	1979		FAA ADAP-01
3	63.1	CITY OF PASO ROBLES	1981		FAA ADAP-01
4	37.5	CITY OF PASO ROBLES	1993		FAA AIP-09
5	30			2003-2007	
6	4			2003-2007	
7	45			2013-2020	
8	95			2013-2020	

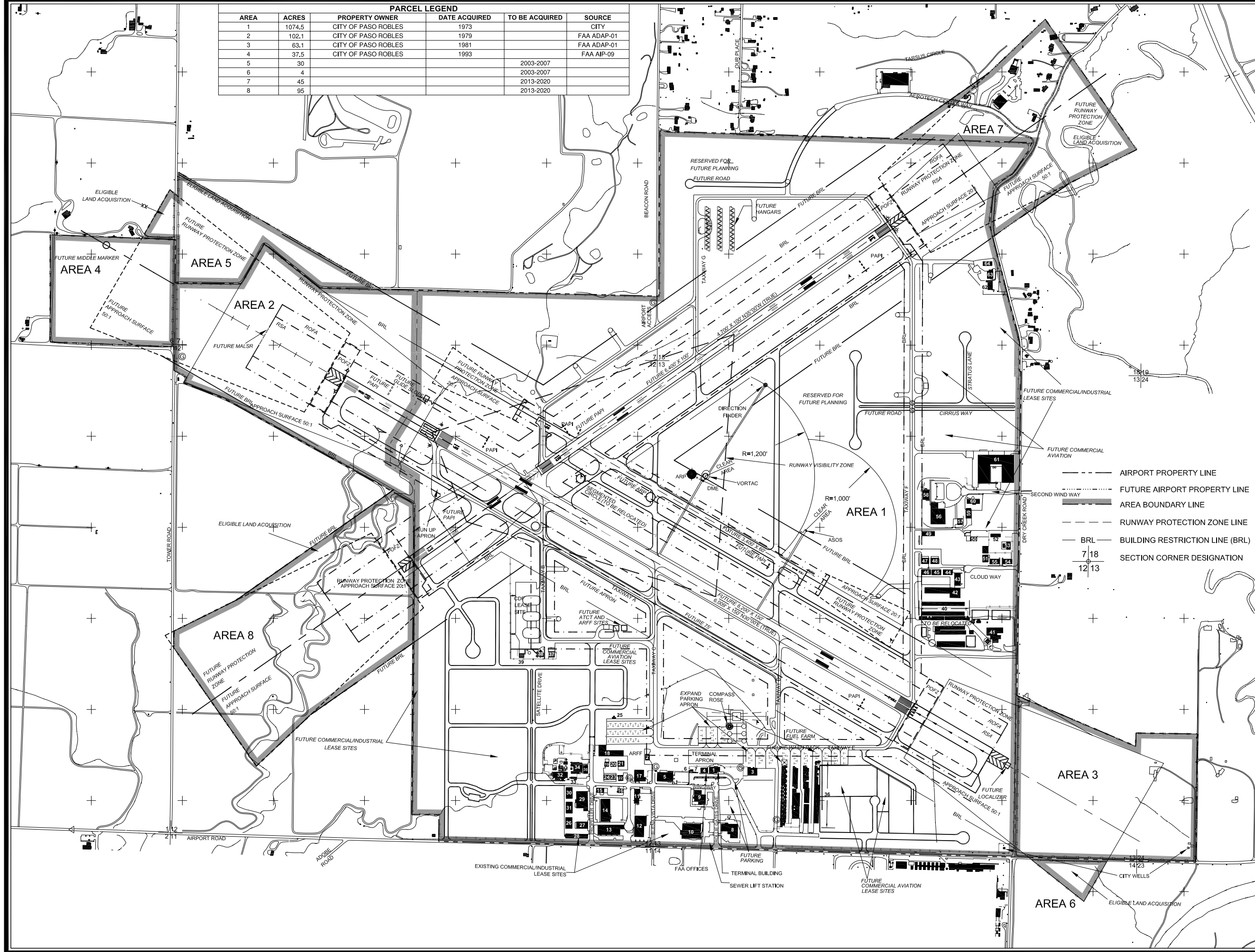

PASO ROBLES MUNICIPAL AIRPORT

AIRPORT PROPERTY MAP (EXHIBIT "A")

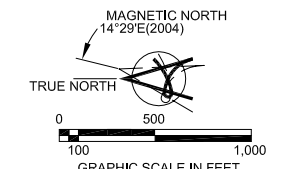

NOTE:
THIS DRAWING IS FOR PLANNING PURPOSES ONLY AND IS NOT INTENDED FOR CONSTRUCTION OR NAVIGATIONAL PURPOSES.

THE PREPARATION OF THIS DOCUMENT WAS FINANCED IN PART THROUGH AN AIRPORT IMPROVEMENT PROGRAM GRANT FROM THE FEDERAL AVIATION ADMINISTRATION UNDER THE PROVISIONS OF SECTION 505 OF THE AIRPORT AND AIRWAY IMPROVEMENT ACT OF 1982, AS AMENDED.

- AIRPORT PROPERTY LINE
- FUTURE AIRPORT PROPERTY LINE
- AREA BOUNDARY LINE
- RUNWAY PROTECTION ZONE LINE
- BRL BUILDING RESTRICTION LINE (BRL)
- 7 18 12 13 SECTION CORNER DESIGNATION

NO.	ALP APPROVED REVISIONS	1/17/96 DATE
1	ALP APPROVED	1/17/96

FAA APPROVAL

BY _____
CITY OF PASO ROBLES DATE

VARIES CONSULTANTS LTD.

PASO ROBLES MUNICIPAL AIRPORT	SHEET 7 OF 7
SAN LUIS OBISPO COUNTY, CALIFORNIA	
NAME: PRB-7-Property Map-B.dwg NO: 4080-02	
DATE: November 16, 2004	PLOT SCALE: 1"= 1,000'